



Nombre del producto

## Extractores de rótulas tipo con leva







Para expulsar el pivote de rótula al desmontar rótulas y cabezas de tirantes en tirantes para automóviles y camionetas ligeras.

Núm. art. 129-0-29

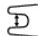
Serie 129

EAN 4021176989674

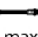

	Atributo técnico	Métrico	Imperial
	Apertura de horquilla	29,5 mm	1 3/16 inch
	Zona de sujeción de la palanca	50 mm	2 inch
 DIN ISO 7803	Para rótulas de tamaño nominal	30 - 35 mm	
für for	Uso	Polo (02), Golf (04/05), Caddy, A 2 (01), A 6(98), A 8 (94), Passat (06), TT (99), Touran (04), LT (97)u.a.	Polo (02), Golf (04/05), Caddy, A 2 (01), A 6(98), A 8 (94), Passat (06), TT (99), Touran (04), LT (97)u.a.
	Peso	1.245 kg	
	Momento de giro máximo	45 Nm	33.1 ft lb
max.	Carga máxima admisible	6,5 t	7.1 US t
	Altura de boca mín.	1,7 - 11 mm	1/8 - 3/8 inch
	Altura de boca máx.	mm	inch

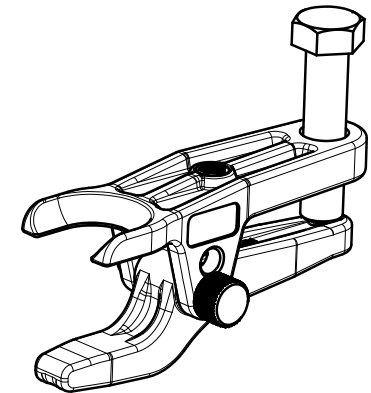
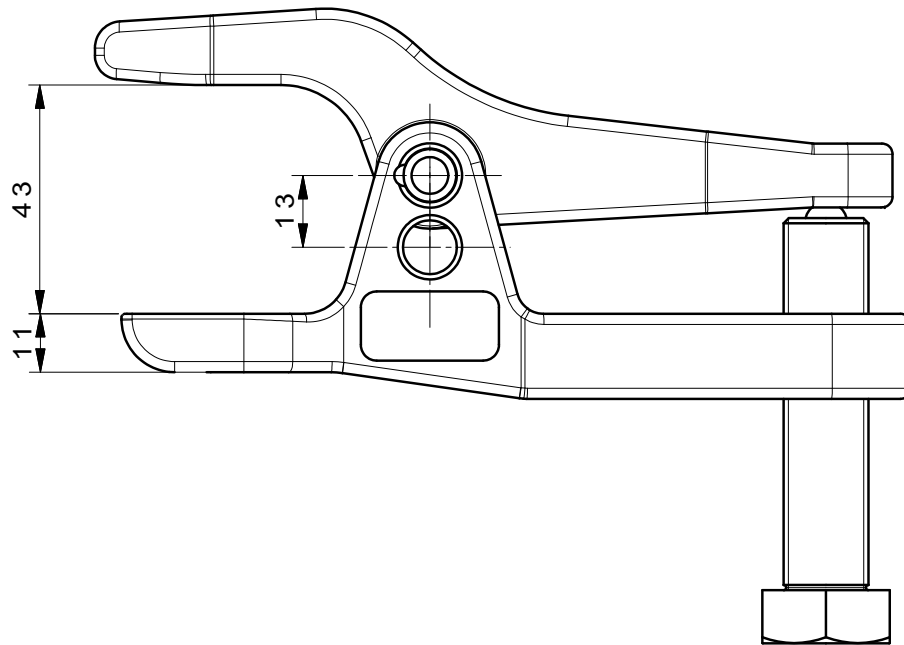
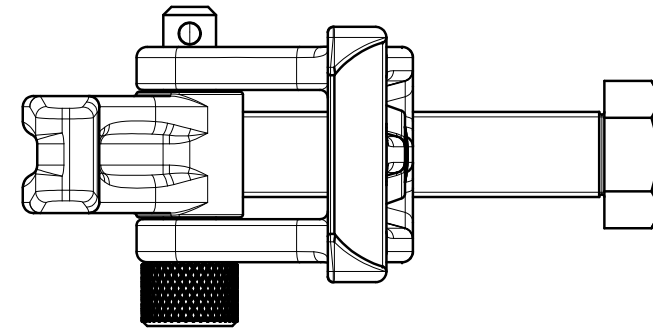
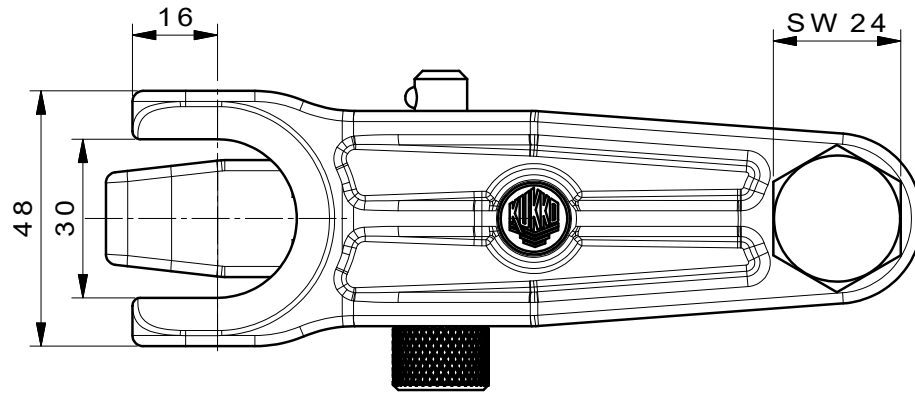

 <b>Kleinbongartz &amp; Kaiser oHG</b> Werkzeugfabrik Hilden - Germany	Dokumentname: 129-0-29_Kugelgelenk-Ausdrücker		Toleranz: DIN ISO 2768-m		
	Dokumentbeschreibung: BAUGRUPPENZEICHUNG			Material: Hoch legierter Werkzeugstahl / High alloy tool steel	
	Erstellt von: Breidenbach		Erstellungsdatum: 07/12/2016		Maßstab: 1:1
Teilbeschreibung: Kugelgelenk-Ausdrücker mit Hebelübersetzung für PKW/ Adjustable ball joint extractors lever type			Wärmebehandlung / Härte: vergüteter Stahl/ tempered steel		
			Oberflächenbehandlung:		
Artikelnummer / ZNR.: 129-0-29		Dokumentversion: -		Schutzvermerk ISO 16016 beachten	