



Nome do produto

Extrator de 2 braços com ajuste rápido e gancho cruzado com pés de garra







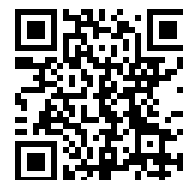

Para espaços estreitos, durante a extração de pinhões, rolamentos e peças semelhantes.

Artigo Nº 14-01

Série 14

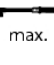
EAN 4021176459559

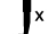

	Características	Métrico	Polegada
	Extensão externa	6 - 100 mm	1/4 - 3 7/8 inch
	Profundidade de fixação	85 mm	3 3/8 inch
	Número do ajuste da profundidade de fixação	3	3
	Hexágono externo	13 mm	
max.	Carga máxima permitida	1 t	1 US t
	Binário máx.	30 Nm	22 ft lb
	Peso	0.45 kg	
	Quarto abaixo	2,5 mm	1/8 inch
	Quarto de drenagem secundária	8,5 mm	3/8 inch
	Número de ganchos	2	2



Tecnologias



SWITCH

Ajuste ótimo do fuso ao eixo graças à ponta do fuso de duas faces.



Peça de substituição

Artigo Nº	Nome do produto
612130	Eixo de compressão mecânico.
14-1-T	Travessa
14-01-85-P	2 ganchos de extração (par)
060704	Par de pino de encaixe

Acessórios

Artigo Nº	Nome do produto
K-600-014	Peça de pressão de substituição - Conjunto para KUKKO fusos de pressão

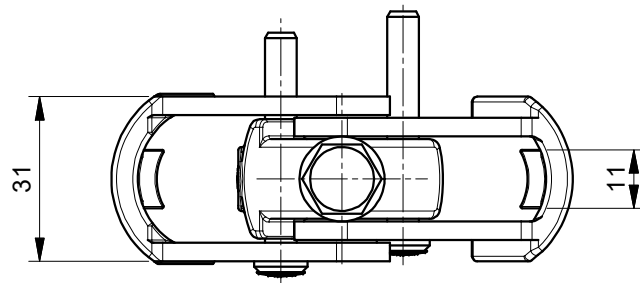
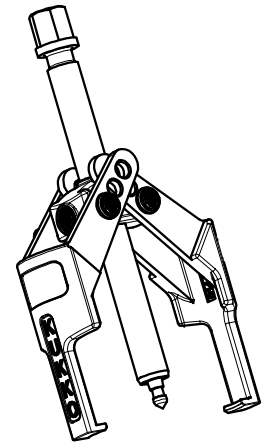
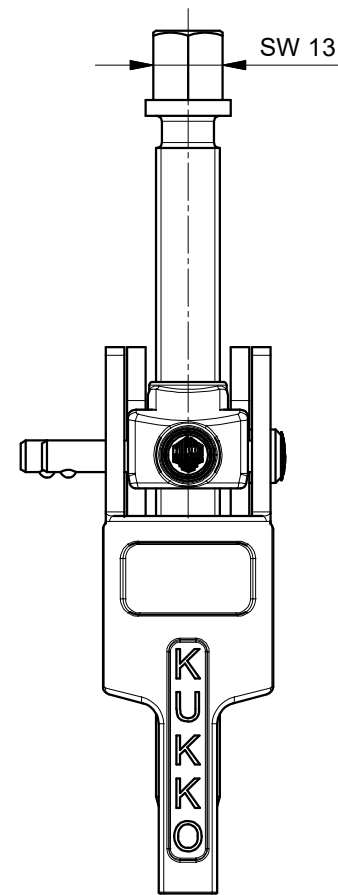
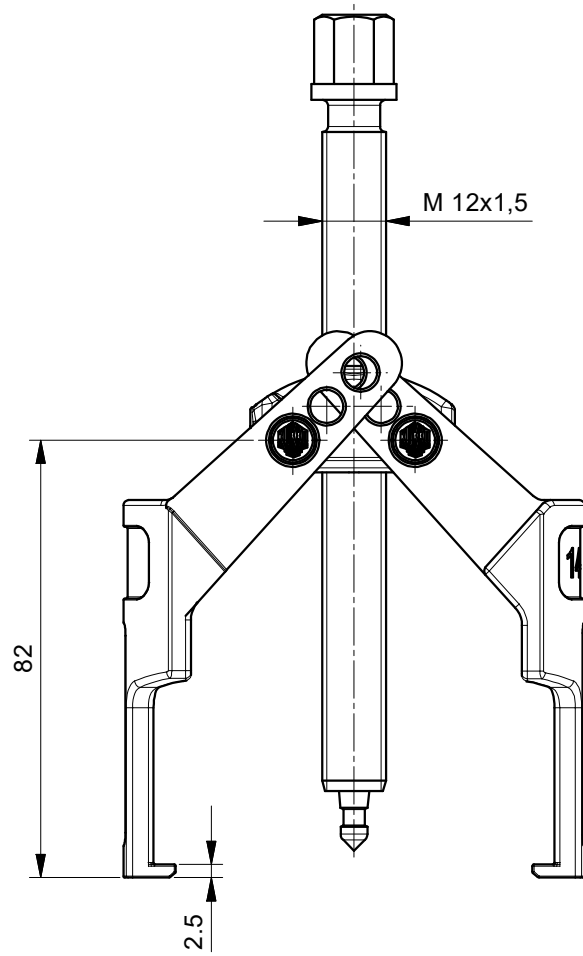

 Kleinbongartz & Kaiser oHG Werkzeugfabrik Hilden - Germany	Dokumentname: 14-01_Abzieher mit Schnellverstellung		Toleranz: DIN ISO 2768-m		
	Dokumentbeschreibung: Baugruppe			Material: Hoch legierter Werkzeugstahl / High alloy tool steel	
	Erstellt von: Breidenbach		Erstellungsdatum: 14/06/2018		Maßstab: 1:1
Teilbeschreibung: 2-armiger Abzieher mit Schnellverstellung und Kreuzhaken mit Krallenfüßen/ 2-jaw puller with quick adjusting capability and T-jaws with claw feet			Wärmebehandlung / Härte: vergüteter Stahl/ tempered steel		
Oberflächenbehandlung:			Oberflächenbehandlung:		
Artikelnummer / ZNR.: 14-01		Dokumentversion: -		Schutzvermerk ISO 16016 beachten	