



产品名称

两爪拉马带快速调节能力和T型爪脚









用于当拉动链轮、轴承和类似零件时，保持空间紧密。

编号 14-01

系列 14

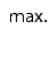
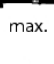
EAN 4021176459559



技术规格	公制	英制
 跨度	6 - 100 mm	1/4 - 3 7/8 inch
 深度	85 mm	3 3/8 inch
 可能深度	3	3
 六角驱动 (公)	13 mm	
 max. 最大负载	1 t	1 US t
 max. 最大扭矩	30 Nm	22 ft lb
 重量	0.45 kg	
 下方空间	2,5 mm	1/8 inch
 邻近空间	8,5 mm	3/8 inch
 x 拉马爪数量	2	2



技术



开关

通过两边的轴尖来调整优化主轴的位置。



配件

编号	产品名称
612130	机械压力主轴。
14-1-T	横梁
14-01-85-P	两只拉马爪（对）
060704	塞销，对

附件

编号	产品名称
K-600-014	KUKKO 压紧轴的可更换承压件套件

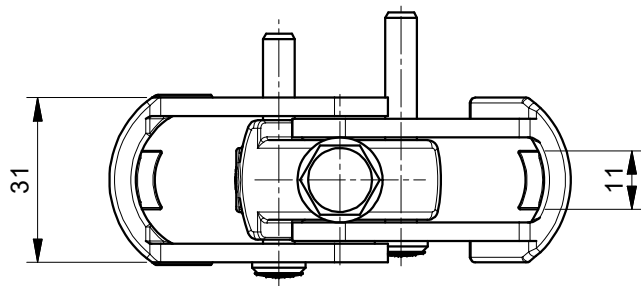
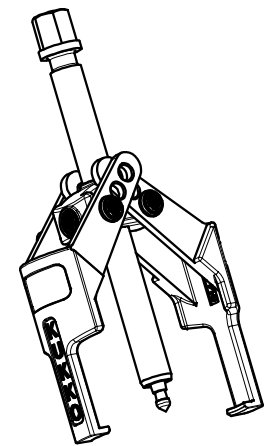
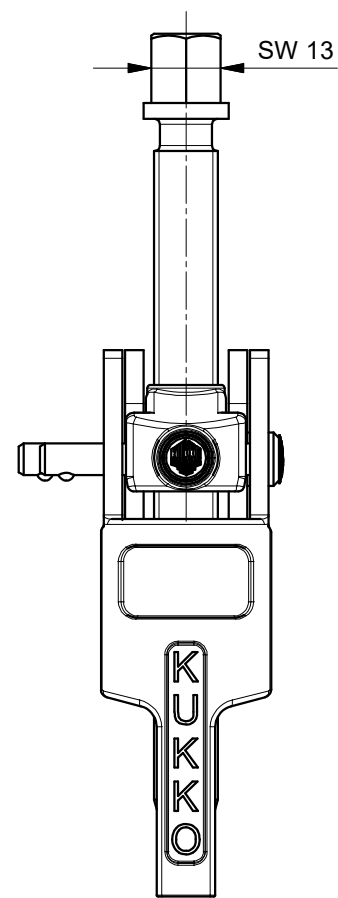
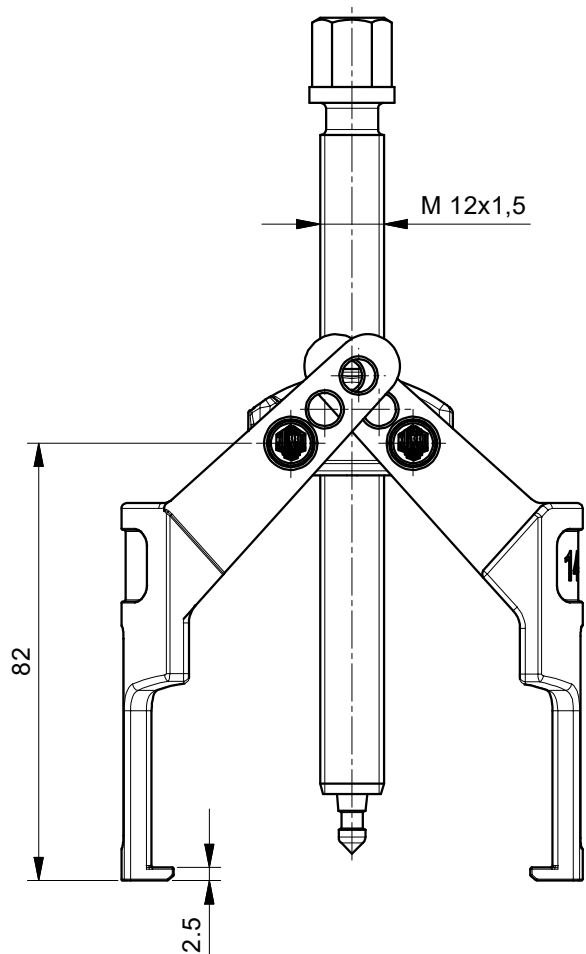

 Kleinbongartz & Kaiser oHG Werkzeugfabrik Hilden - Germany	Dokumentname: 14-01_Abzieher mit Schnellverstellung	Toleranz: DIN ISO 2768-m
	Dokumentbeschreibung: Baugruppe	Material: Hoch legierter Werkzeugstahl / High alloy tool steel
	Erstellt von: Breidenbach	Erstellungsdatum: 14/06/2018
Teilbeschreibung: 2-armiger Abzieher mit Schnellverstellung und Kreuzhaken mit Krallenfüßen/ 2-jaw puller with quick adjusting capability and T-jaws with claw feet		Wärmebehandlung / Härte: vergüteter Stahl/ tempered steel
Oberflächenbehandlung:		Schutzvermerk ISO 16016 beachten
Artikelnummer / ZNR.: 14-01	Dokumentversion: -	