



Product name

Internal extractor with segmented grasp edge

For extracting bearings, bearing outer rings and bushings that lay flat on one another.

Art. No. 21-01-E

Series 21-E

EAN 4021176909177

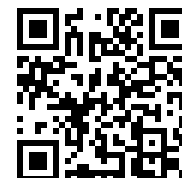

Technical attribute

Metric

Imperial



Ball bearing ISO

6000; 6200; 6300;	6000; 6200; 6300;
6800; 6900; 61800;	6800; 6900; 61800;
61900; 62200;	61900; 62200;
62300; 6001; 6201;	62300; 6001; 6201;
6301; 6801; 6901;	6301; 6801; 6901;
16001; 16101;	16001; 16101;
61801; 61901;	61801; 61901;
62201; 62301	62201; 62301



Inner diameter of ball bearing

9,5 - 12,5 mm

3/8 - 1/2 inch



Effective depth

30 mm

1 3/16 inch



Length of internal extractor

54 mm

2 1/8 inch



Number of segments

2

2



Spanner size of the internal extractor

13 mm



Weight

0.05 kg



has to be accomplished with



Slide hammer device

22-0



Slide hammer device

22-0-1



Counterstay

22-1



Counterstay

22-2



Goes with

Art. No.	Product name
22-1	Counterstay
22-2	Counterstay

Part of

Art. No.	Product name
27-A	Universal puller set
K-22-C-E	Ball bearing extracting set with counterstay and slide hammer
K-22-A-E	Ball bearing extracting set with counterstay and slide hammer

Spare part of

Art. No.	Product name
27-A	Universal puller set

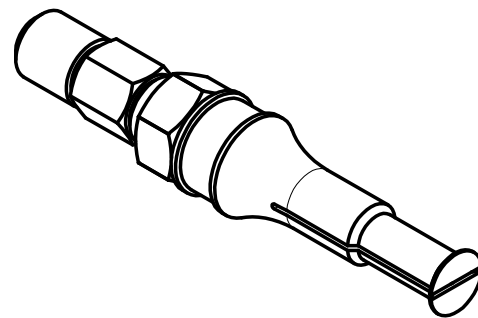
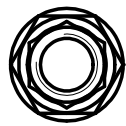
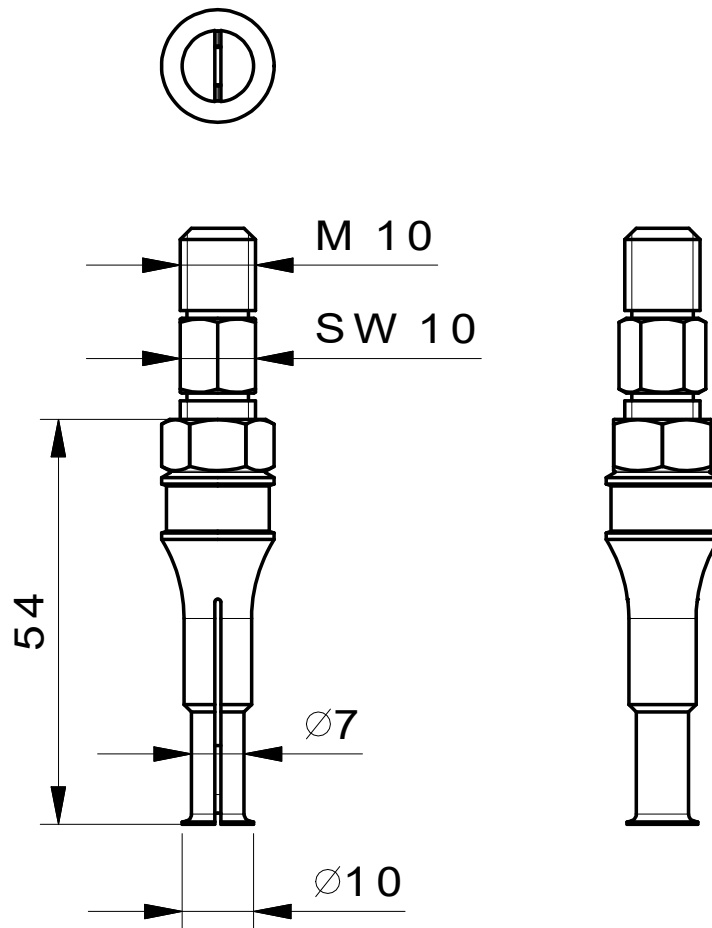

**Kleinbongartz
& Kaiser
oHG**
Werkzeugfabrik
Hilden - Germany

Dokumentname:
21-01-E_Segment-Innenauszieher

Toleranz:
DIN ISO 2768-m

Dokumentbeschreibung:
Baugruppe

Material:
Hochfester extra zäher Vergütungsstahl/
High tensile strength and toughness steel

Erstellt von:
Schultes

Erstellungsdatum:
03/05/2016

Maßstab:
1:1

Teilbeschreibung:

Segment-Innenauszieher /
Internal extractor with segmented grasp edge

Wärmebehandlung / Härte:
vergüteter Stahl/ tempered steel

Oberflächenbehandlung:

Artikelnummer / ZNR.:
21-01-E

Dokumentversion:
-

Schutzvermerk
ISO 16016
beachten