



Product name

## Internal extractor

For extracting inner bearings, bearing outer rings and bushings.

Art. No. 21-5

Series 21

EAN 4021176011498

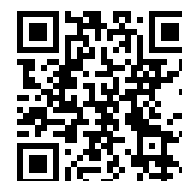

### Technical attribute

### Metric

### Imperial



Ball bearing ISO

6006; 6206; 6306;	6006; 6206; 6306;
6406; 16006; 61806;	6406; 16006; 61806;
61906; 6007; 6207;	61906; 6007; 6207;
6307; 6407; 16007;	6307; 6407; 16007;
61807; 61907; 6008;	61807; 61907; 6008;
6208; 6308; 6408;	6208; 6308; 6408;
16008; 61808;	16008; 61808;
61908	61908



Inner diameter of ball bearing

28 - 40 mm      1 3/16 - 1 5/8 inch



Effective depth

30 mm      1 3/8 inch



Length of internal extractor

101 mm      4 inch



Number of segments

2      2



Weight

0.395 kg



has to be accomplished with



**Slide hammer device**

22-0



**Slide hammer device**

22-0-1

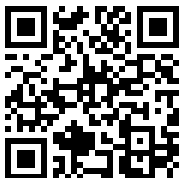

**Counterstay**

22-1



**Counterstay**

22-2



## Accessories

<b>Art. No.</b>	<b>Product name</b>
21-V-0	Set of extensions for internal extractors

## Goes with

<b>Art. No.</b>	<b>Product name</b>
22-1	Counterstay
22-2	Counterstay

## Part of

<b>Art. No.</b>	<b>Product name</b>
24-A	Set of bearing pulling and extracting tools
24-B	Set of bearing pulling and extracting tools
24-C	Set of bearing pulling and extracting tools
25-A	Set of bearing extracting tools
25-B	Set of bearing extracting tools
25-C	Set of bearing extracting tools
28-B	Set of slide hammer for extracting ball bearings and dowel-pins
28-C	Set of slide hammer and counterstays for extracting ball bearings and dowel-pins
28-D	Set of slide hammer and counterstays for extracting ball bearings and dowel-pins



## Part of

<b>Art. No.</b>	<b>Product name</b>
WT-017	Puller product range - interior pulling - BASIC
WT-018	Puller product range - interior pulling - TOP
K-22-B	Ball bearing extracting set with counterstay and slide hammer
EVLW-2-INDUSTRIE	Display
EVLW-2-KFZ	Merchandiser, automotiv pullers
EVLW-2-NFZ	Merchandiser, automotive pullers / commercial vehicle / agricultural machinery
WT-1-INDUSTRIE	Puller product range - industrial
EVLW-INDUSTRIE BASIC	Display

## Spare part of

<b>Art. No.</b>	<b>Product name</b>
24-A	Set of bearing pulling and extracting tools
24-B	Set of bearing pulling and extracting tools
25-A	Set of bearing extracting tools
25-B	Set of bearing extracting tools
25-C	Set of bearing extracting tools



## Also included in

**Art. No.**

**Product name**

WT-018

Puller product range - interior pulling - TOP

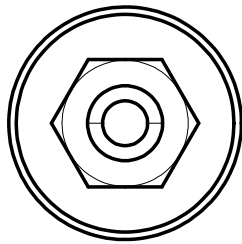
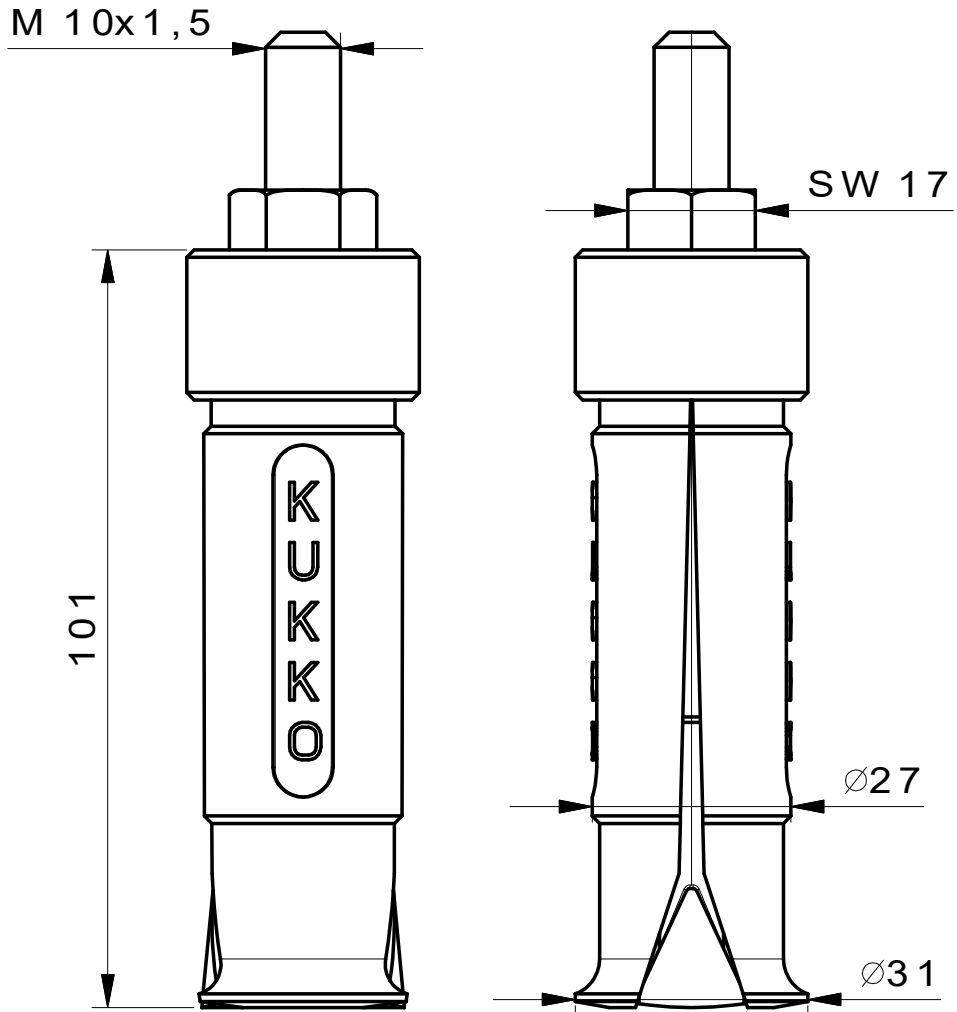

 <p><b>Kleinbongartz &amp; Kaiser oHG</b> Werkzeugfabrik Hilden - Germany</p>	Dokumentname: 21-5 Innenauszieher		Toleranz: DIN ISO 2768-m	
	Dokumentbeschreibung: Baugruppe		Material: Hochfester extra zäher Vergütungsstahl/ High tensile strength and toughness steel	
	Erstellt / Geprüft von: Schultes	Erstellungsdatum: 30/03/2015	Maßstab: 1:1	
Teilbeschreibung: Innenauszieher/ Internal extractor			Wärmebehandlung / Härte: vergüteter Stahl/ tempered steel	
			Oberflächenbehandlung:	
Artikelnummer / ZNR.: 21-5	Dokumentversion: -		Schutzvermerk ISO 16016 beachten	