



Product name

3-shell internal extractor

For extracting inner bearings, bearing outer rings and bushings.

Art. No. 21-90

Series 21

EAN 4021176012068



Technical attribute

Metric

Imperial



Ball bearing ISO

Metric	Imperial
6020; 6220; 6320;	6020; 6220; 6320;
16020; 61820; 6022;	16020; 61820; 6022;
6222; 6322; 16022;	6222; 6322; 16022;
61822; 6024; 6224;	61822; 6024; 6224;
16024; 61824; 6026;	16024; 61824; 6026;
6226; 61826; 6028;	6226; 61826; 6028;
6228; 61828; 6030;	6228; 61828; 6030;
61830; 6032; 61832;	61830; 6032; 61832;
6034; 61834; 6036;	6034; 61834; 6036;
61838; 6040; 61840	61838; 6040; 61840



Inner diameter of ball bearing

100 - 200 mm

3 7/8 - 7 7/8 inch



Effective depth

175 mm

6 7/8 inch



Length of internal extractor

220 mm

8 5/8 inch



Number of segments

3

3



Weight

6.58 kg



has to be accomplished with

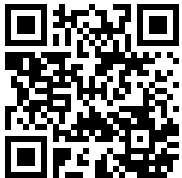

Slide hammer device

22-0-2

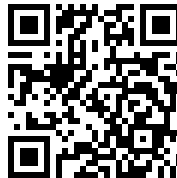

Counterstay

22-5



Spare part

Art. No.	Product name
21-90-6	Spindle
VM34-34	female adapter
021090	3 Extractor segments (set)
21-90-33	2 spreaders (pair)

Goes with

Art. No.	Product name
22-5	Counterstay

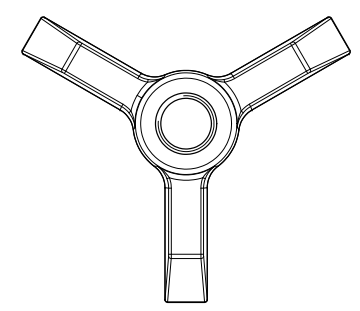
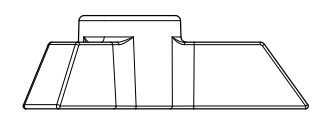
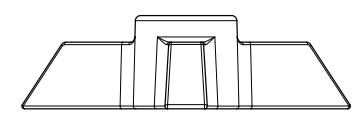
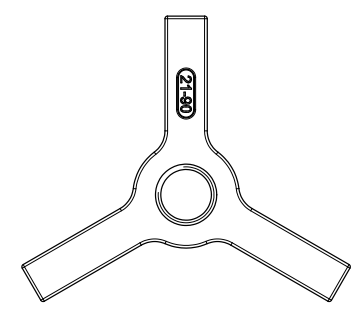
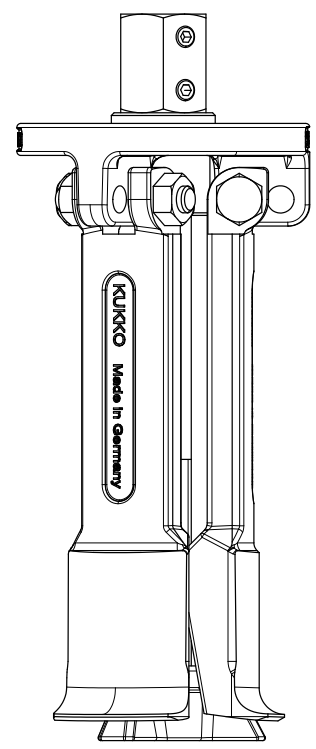
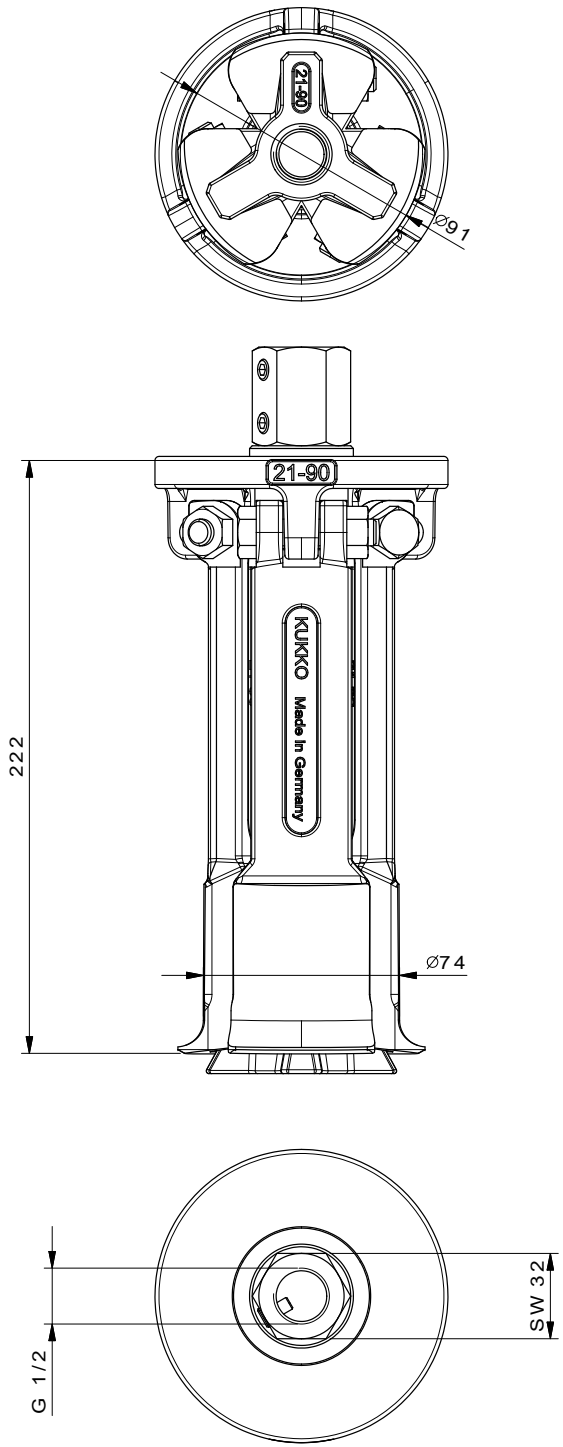

 Kleinbongartz & Kaiser oHG Werkzeugfabrik Hilden - Germany	Dokumentnr.: 21-90 Innenauszieher	Toleranz: DIN ISO 2768-m
	Dokumentbeschreibung: Baugruppe	Material: hochfestes, extra zähes Feingussmetall, 100% verschleißfest und leichtes wiegen
Erweit. / Geprüft von: Schultes	Erstellungsdatum: 30/03/2015	Maßstab: 1:1
Teilbeschreibung: Innenauszieher/ 3-shell internal extractor		Wärmebehandlung / Härte: vergüteter Stahl/ tempered steel
Oberflächenbehandlung:		
Artikelnummer / ZNR.: 21-90	Dokumentversion: -	Schutzvermerk: ISO 16949 zertifiziert